

# TRAINING MODULE APOGEE PREPRESS 8.0

## WORKING WITH JDF-JMF

# Sample



This document is only a preview of the training module.

If you would like to obtain more information about this training module, please contact your local Agfa sales or service representative.

Worldwide addresses of our local Agfa representatives can be found on our Agfa Graphics website:

[http://www.agfagraphics.com/global/en/mainings/about\\_us/worldwide/index.jsp](http://www.agfagraphics.com/global/en/mainings/about_us/worldwide/index.jsp)

**:APOGEE PREPRESS**

## Prerequisites

Ensure that the following Task Processors are installed:

- JDF Import
- Apogee Preflight
- Run List
- Apogee Impose

Setup JDFServer configuration settings as in screenshot below.

First make screenshots of the configuration settings (To reset afterwards).

The image displays two screenshots of the JDF Server configuration interface, showing various settings for Planless Submission and Product Integration.

**Left Screenshot (Planless Submission):**

- Production Plan: Build dynamically (selected), Use Ticket Template
- Output device: TIFF Platesetter
- Imposition Proofer: PDF Proofer
- Proofer Data By: Separate Render (radio button), Digital Film Proof (radio button, selected)
- Page Proofer: PDF Proofer
- Press: Initial
- JMF Input: Use Hot Folder, Web Upload and Document pre-process from JDF Import parameter set: Initial
- Action Points:
  - Main flow:
    - Soft Proof before Impose (checkbox)
    - Hard Copy Proof before Render (checkbox)
    - Keep Result on Render (checkbox)
    - Collect for Output on Output Device (checkbox, checked)
    - Start printing automatically (checkbox)
  - Proofing flows:
    - Collect for Output on Proofing Device (checkbox)
    - Soft Proof before each Render (checkbox)
- Put Job on Hold (checkbox)
- Put Intent Job on Hold (checkbox, checked)

**Right Screenshot (Product Integration):**

- JDF Attribute Mapping: Base Attribute Map: Generic Multipart MIS and Intent Jobs
- Mis URL: (empty field)
- Use Pagemaster's default collaborators (checkbox)
- Approval Webservice: WebApproval Exercise
  - HostName: MyWebApprovalServer
  - PortNumber: 10090
- Apogee Prepress Webservice:
  - Port: 80
  - Specify the port number that is used by Apogee Prepress's Tomcat web server.
  - Note that this does not set the port number.
- Input:
  - Pre-process: Run script on incoming JDF (checkbox, checked)
    - Script path: \\apesx1s7\{SupportFiles}\JDFProcessingScripts\universalScript.vbs
    - Optional arguments: argumentfile@"universalscriptargs.txt"
  - Content Files: Remove content files on external servers (checkbox)
  - Thumbnails: Extract thumbnails from PDF (checkbox, checked)



## Introduction to JDF-JMF

What is JDF (Job Description Format)

- Industry Standard [XML](#)-based File format
- [Digital job bag](#)
- Streamlines information exchange between different applications and systems
- Can be created by [MIS/StoreFront/Apogee WebApproval/Imposition application/Acrobat/Apogee Prepress/...](#)

Which info can be included in JDF

- Administrative info (e.g. job name, comments, customer info).
- Number of pages.
- Parts (cover, body...)
- Content pdf placement. Usually MIS systems don't provide this info.
- Description of the production flows (e.g. main output, imposition proofing...).
- Layout (imposition application): imposition layout in detail
- Stripping info (MIS system): imposition layout in less detail, doesn't describe which imposition marks need to be placed.
- Processing information (e.g. paper stock, parameter sets, separations, screening...).

What is JMF (Job Messaging Format )

- Industry Standard XML-based File format
- Message used to communicate between MIS/workflow system /Press controller/finishing equipment/other..., e.g. events, status, ...

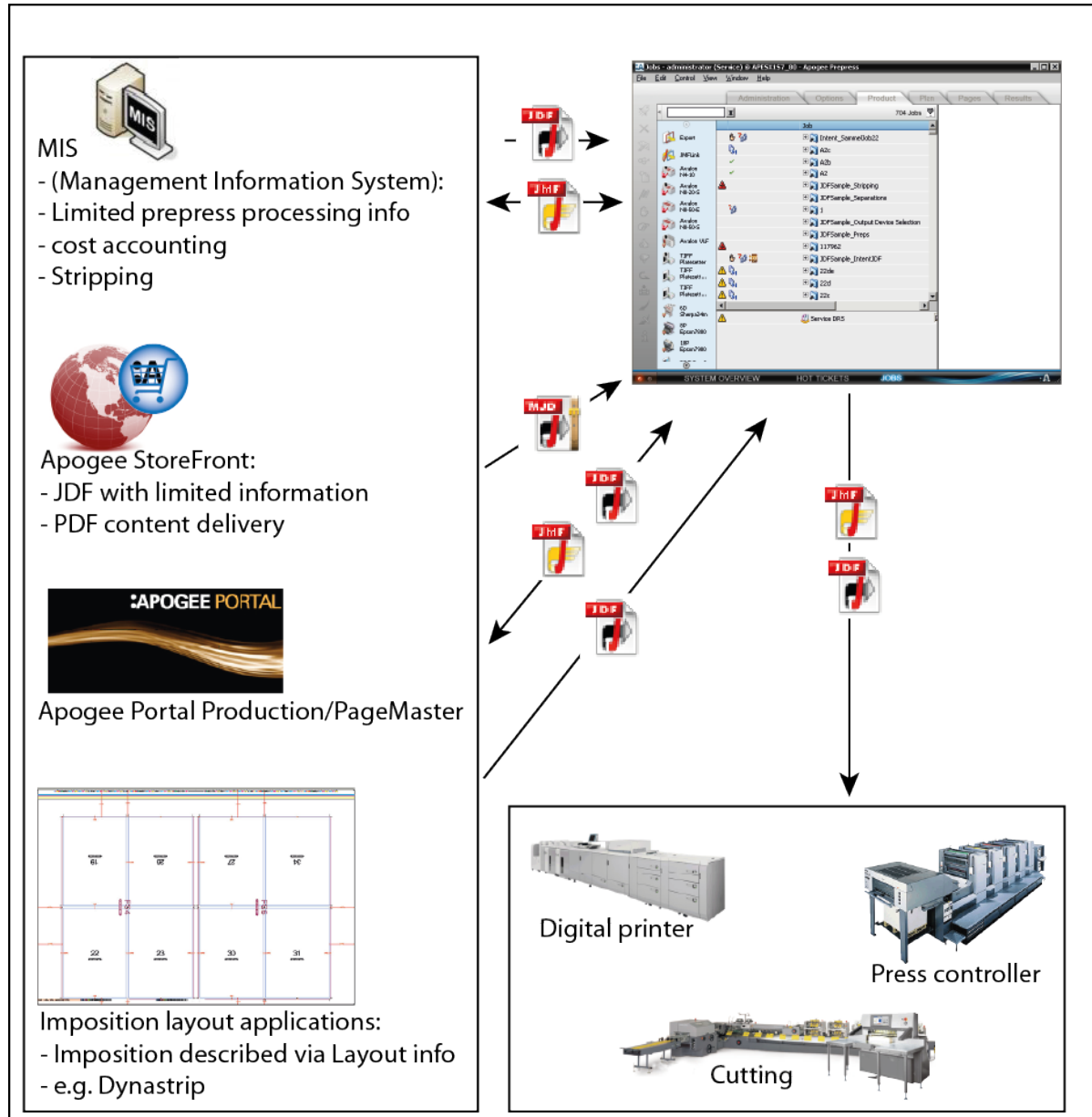

### 1. Fixed production plan [ESSENTIAL]

#### 1. Submit hotticket [Working with JDF-JMF Hotticket with plan.ah](#)

Hotticket with full production plan must contain:

- JDFImport task processor: Check “Enable Job’s hot folder” if resulting job’s input channel must be enabled.
- Runlist
- Impose if job requires imposition. Set impose setting to “imposition selection undefined”. If the JDF contains imposition information, the setting “imposition selection undefined” is ignored.

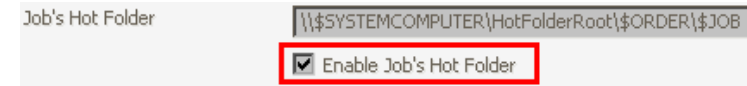

#### 2. Copy [JDFInput\\_Plan\\_Administrative.jdf](#) and [JDFInput\\_Plan\\_Stripping.jdf](#) to the hot ticket’s JDF import hotfolder.

2 jobs are created:

JDFInput\_Plan\_Administrative:

- Hotfolder input channel is enabled
- Info from JDF is added to Administration tab Comments field
- Production plan is the same as hotticket
- Parameter settings are the same as hotticket

JDFInput\_Plan\_Stripping:

- Hotfolder input channel is enabled
- Info from JDF is added to Administration tab Comments field
- Part of the production plan is the same as hotticket.
- An additional proofing flow is added because JDF specifies a proofing flow
- Two parts are created, different processing is enabled and some parameter sets are overwritten.

Generic Press : Small Press	
Production Set	Parameter Set
Cover	Small Press
Body	Large Press CMYK

*Exercise-1: Create a new fixed hotticket for JDF jobs***1. Create and submit a new hotticket for the following JDF's**

- JDF's only contain Administrative info and customer info
- Resulting job should output to tiff platesetter and to page proofer
- When job arrives in Prepress, Prepress operator will create the composition manually
- The jobs hot folder should not be enabled by default
- If a user would copy a pdf with a spot, the spot should be converted

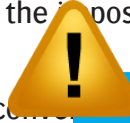
**2. Copy [JDFInput Plan Ex1Job1.jdf](#) and [JDFInput Plan Ex1Job2.jdf](#)**

This document is only a preview of the training module.

If you would like to obtain more information about this training module, please contact your local Agfa sales or service representative.

Worldwide addresses of our local Agfa representatives can be found on our Agfa Graphics website:

[http://www.agfagraphics.com/global/en/mainings/about\\_us/worldwide/index.jsp](http://www.agfagraphics.com/global/en/mainings/about_us/worldwide/index.jsp)